

FINGERPRINT LOCK

M201

Installation

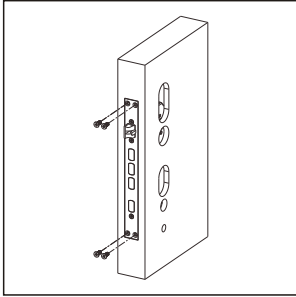

- a** Drill the holes on the door and then install the mortise into the door;

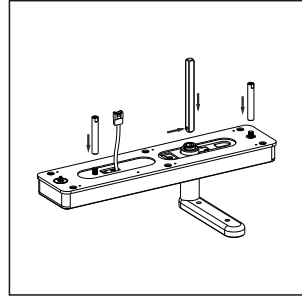

- b** Install the spindle into the handle hole in the front panel, and then insert the rod and fasten it;

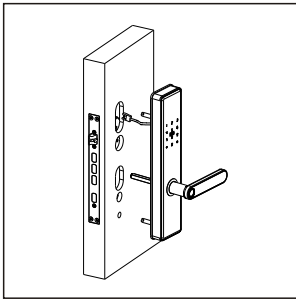

- c** Install the front panel on the door

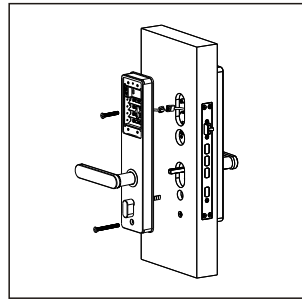

- d** Connect the cable between the front and back panels

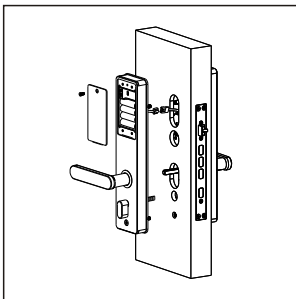

- e** Install the back panel on the other side of door, and then fasten both panels and install the batteries.

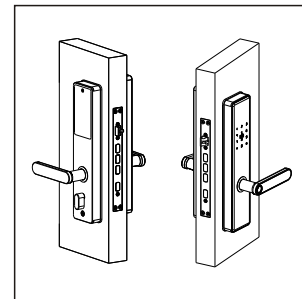

- f** Test the installation to confirm the installation is successful.

Product Guide

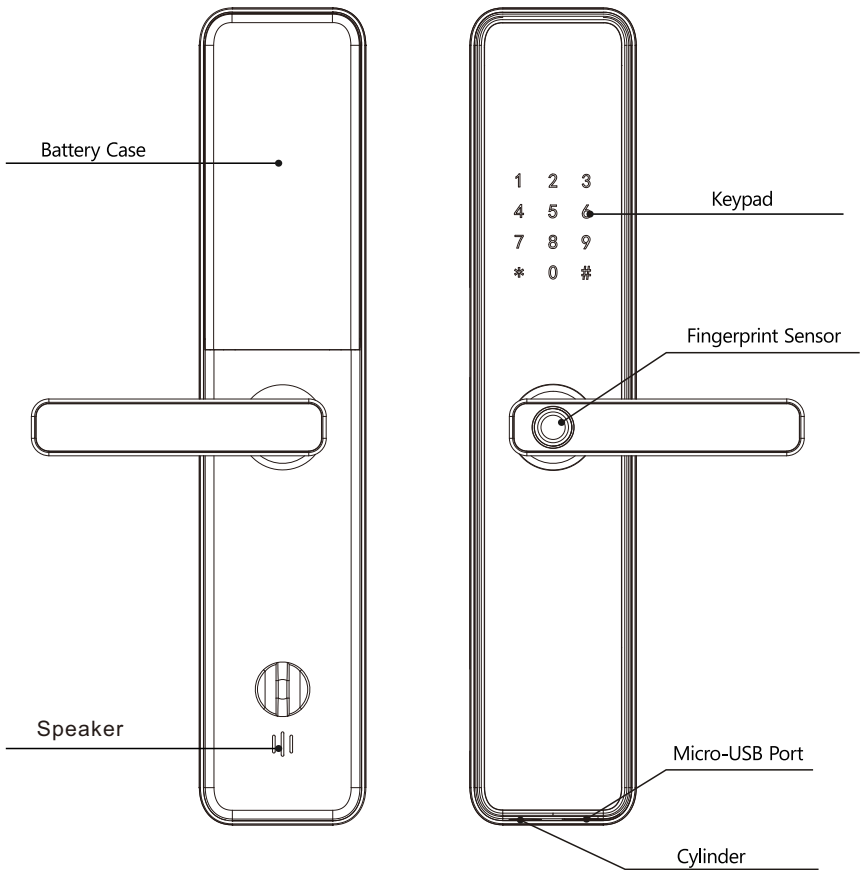

Brief Introduction

1. The default master password is "123-456";
2. There are total 300 users available, 9 users are the master users, 291 are the normal users normal users in the lock;
3. The password can be 6 to 8 digits;
4. The micro-USB port is at the bottom of front panel, which is the port for emergency power supply;
5. The lock has 2 unlocking modes: Single Unlocking Mode and Double Unlocking Mode.

Operation

1 Register Master User

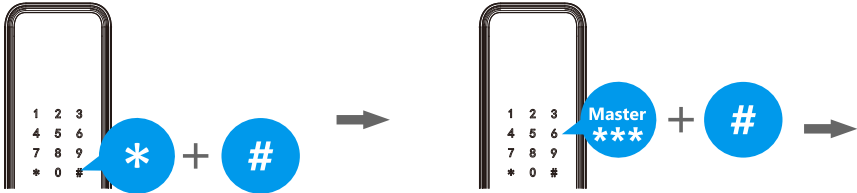

a Input * + #

b Input the master user for authorization, press # to confirm

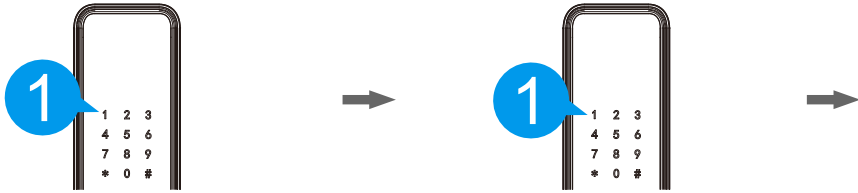

c Input 1 for master user

d Input 1 to register master user

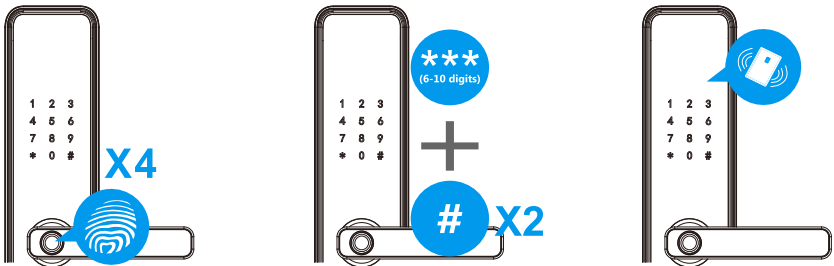

e Fingerprint: place the fingerprint on the sensor for 4 times to register

f Password: input the password, and press # to confirm in 2 times

g Card: place the card close to the card reader to register.



The master password can be 6 to 8 digits;



For new lock, the default master password is "123-456".

When a new master user is registered in the lock, this default password is deleted automatically.



There are up to 9 master users available in the lock.



It is suggested to make a list to record the users' ID numbers for a better management.



Once finishing the operations, please try to unlock the lock to confirm the operation is successful.

2 Add Normal User

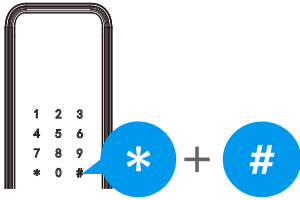

a Input * + #

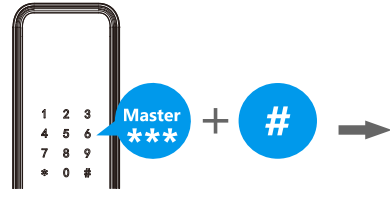

b Input the master user for authorization, press # to confirm



c Input 2 for normal user



d Input 1 to register normal user

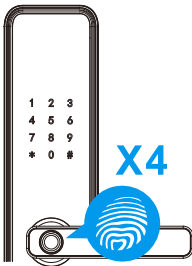

e Fingerprint: place the fingerprint on the sensor for 4 times to register

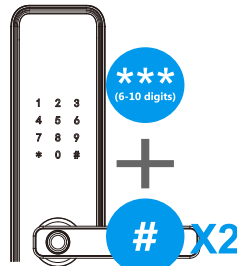

f Password: input the password, and press # to confirm in 2 times

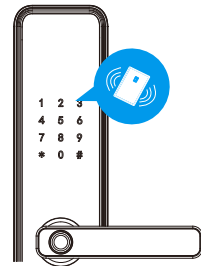

g Card: place the card close to the card reader to register.

 **The password can be 6 to 8 digits;**

 **There are up to 291 normal users available in the lock.**

 **It is suggested to make a list to record the users' ID numbers for a better management.**

 **Once finishing the operations, please try to unlock the lock to confirm the operation is successful.**

3 Delete Master User



a Input * + #



b Input the master user for authorization, press # to confirm

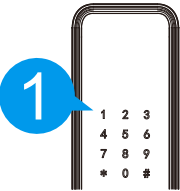

c Input 1 for master user



d Input 2 to delete master user

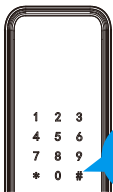

e Input the ID number you want to delete, press # to confirm



The master user which is used to log in the system can not be deleted.



Once finishing the operations, please try to unlock the lock to confirm the operation is successful.

4 Delete Normal User (Single User)

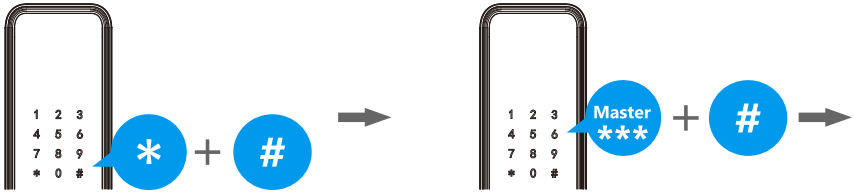

a Input * + #

b Input the master user for authorization, press # to confirm

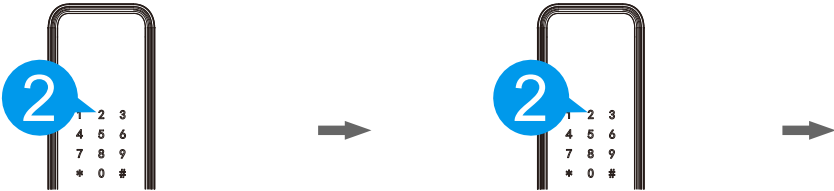

c Input 2 for normal user

d Input 2 to delete single normal user

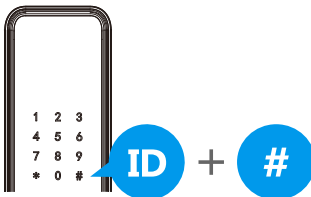

e Input the ID number you want to delete, press # to confirm



Once finishing the operations, please try to unlock the lock to confirm the operation is successful.

5 Unlocking Mode

Sometimes if you need a higher security level, you can set up the lock in double unlocking mode, which the unlock needs 2 registered users for unlocking each time.

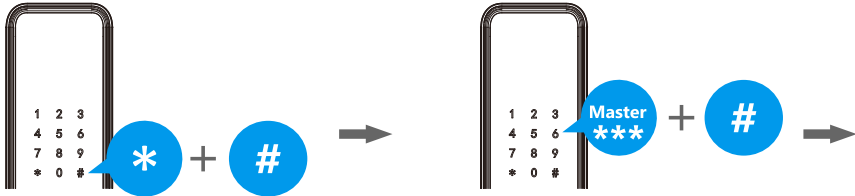

a Input * + #

b Input the master user for authorization, press # to confirm

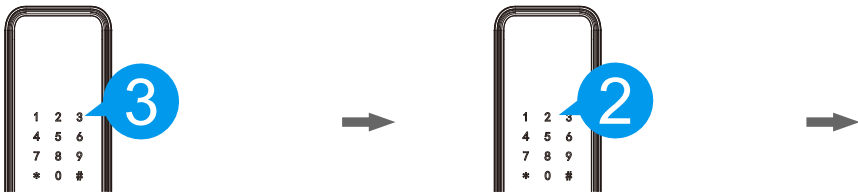

c Input 3 for system setting

d Input 2 for unlocking mode

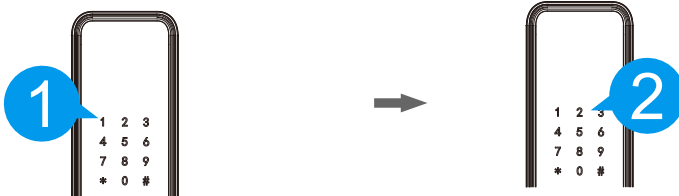

e Single unlocking: input 1

f Double unlocking: input 2



Once finishing the operations, please try to unlock the lock to confirm the operation is successful.



When the lock is under double unlocking mode, you have to input 2 registered users to unlock every time.



The master users can unlock directly even the lock is under double unlocking mode.

6 Voice Setting

You can turn on/off the voice for unlocking

Enable:

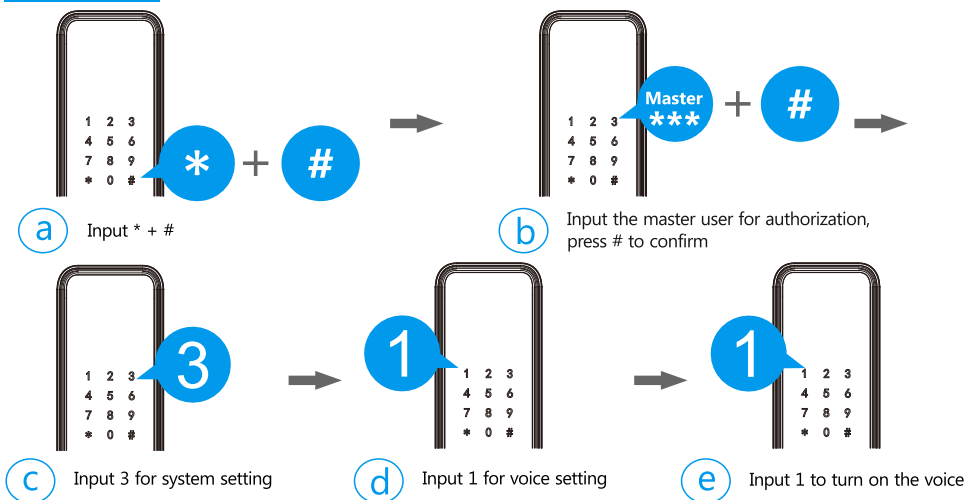

Disable:

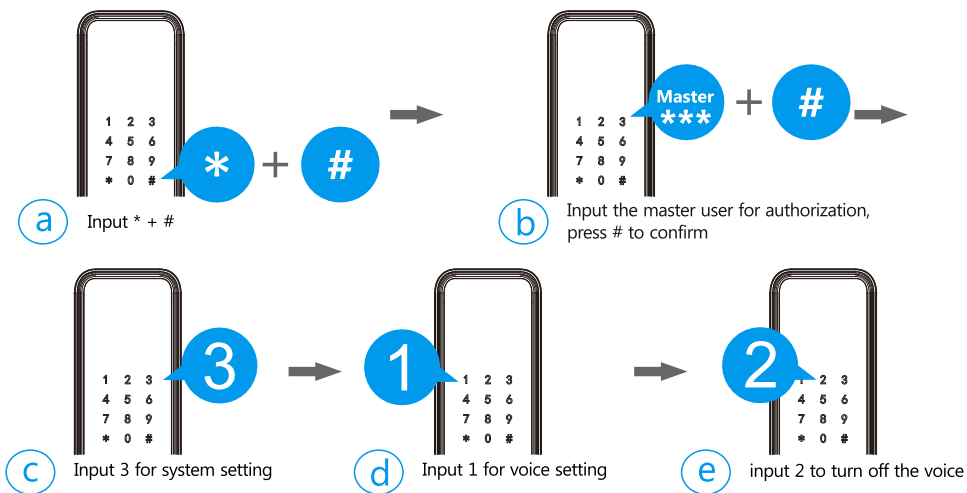

 **Once finishing the operations, please try to unlock the lock to confirm the operation is successful.**

7 Time Setting

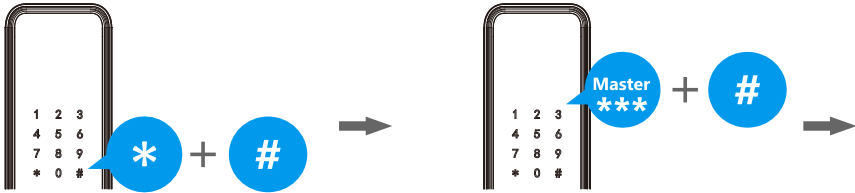

a Input * + #

b Input the master user for authorization, press # to confirm

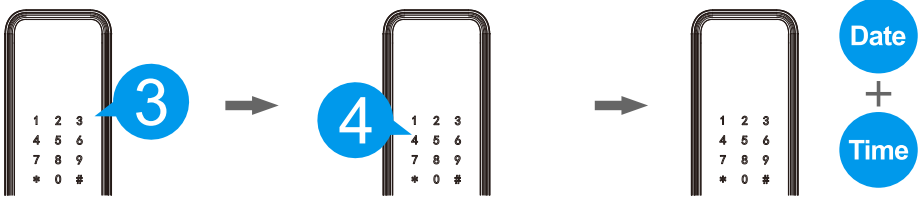

c Input 3 for system setting

d Input 4 for time setting

e Input the new date and time to the lock.

⚠ The format for the date and time is 2 digits, which is Year (XX) – Month (XX) – Day (XX) -Hour (XX) – Minute (XX). For example: March 21th, 2019 at 13:45 is 1903211345.

8 Passage Mode

When the lock is required to unlock frequently, set the lock to passage mode can let the people unlock the lock without any identification.

Enable:

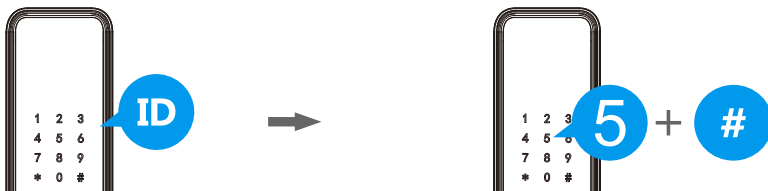

a Place the register user to unlock

b Input 5# to activate the passage mode

Disable:

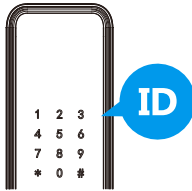

- a Place the registered user to unlock and cancel the passage mode

9 Restore The Lock

When the lock has problems and you can try to restore the lock to solve the problems.

Option # 1

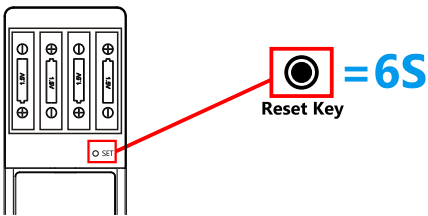

- a Press the reset key in the battery case for 6 seconds, and then the lock will be restored to the factory default. The master password will be restored to "123-456".

Option # 2

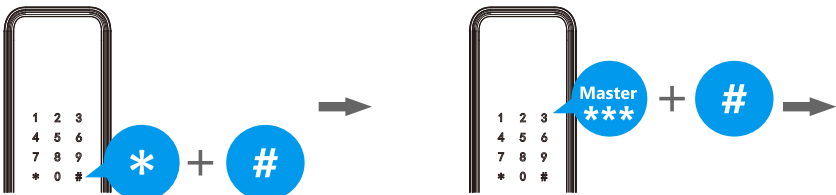

- a Input * + #
- b Input the master user for authorization, press # to confirm



- c Input 4 to restore the lock

10 Tuya Wi-Fi Setting

This function is only available with the lock installed Tuya Chipset (model:M201 Wi-Fi)

1. Download and install the APP on the mobile phone.
2. Register a master user in the lock
3. Select the "Security & Sensors" – "Lock (Wi-Fi)"

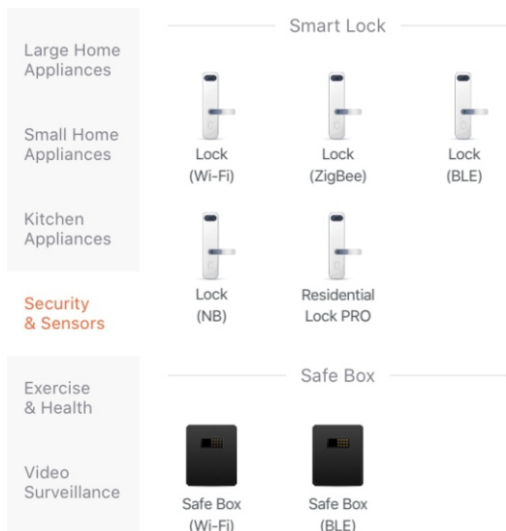

4. Select the Wi-Fi, and input the password for the Wi-Fi;

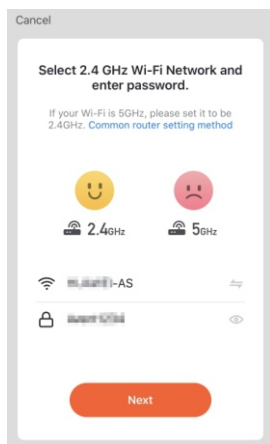

5. Make the connection is "AP Mode", and click next

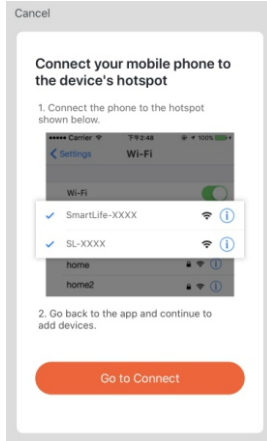
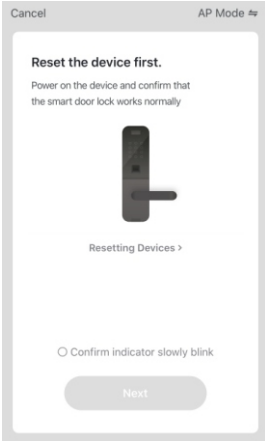

6. Log in the lock system, and input 1 for master user setting, then input 3 for network connection, input 1 for AP mode connection.

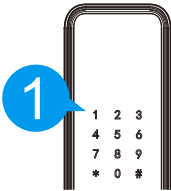

Input 1 for master user

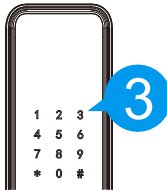

Input 3 for network connection

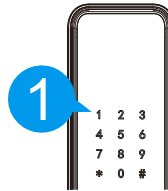

Input 1 for AP mode connection.

7. Go to the WLAN setting in the mobile phone, and select the network which starts with "SmartLife-XXX"

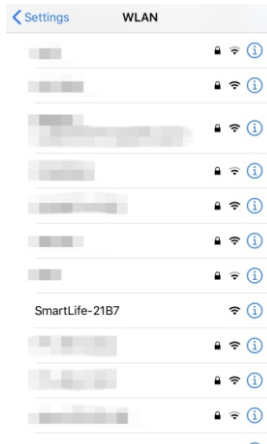
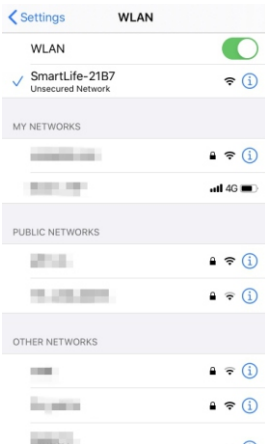

8. Back to the Tuya App, and the App starts to search the lock

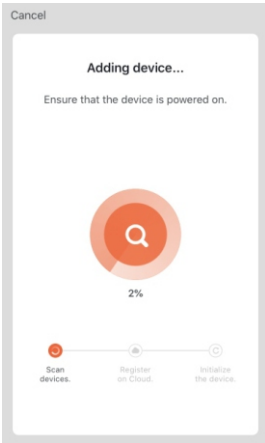

9. Wait some time and the APP will finish the connection with the lock.
You can give the lock a name to manage it easily.

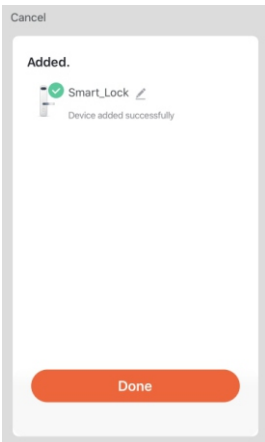

11 Remote Unlock

1. Activate the lock, and input 9+# to send the unlock request to the APP;

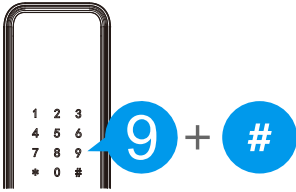

Input 9+# to send the unlock request to the APP

2. The APP will receive a message with unlock request

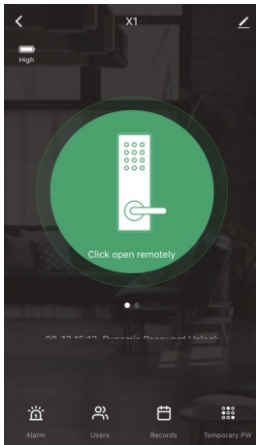

3. Confirm the request to unlock

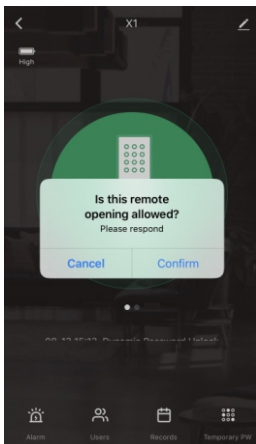

12 Temporary Password Unlock

1. Select the "Temporary PW" option;

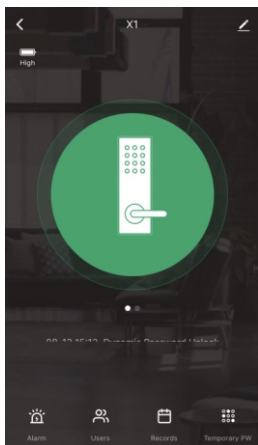

2. Select "Add" to generate the password;

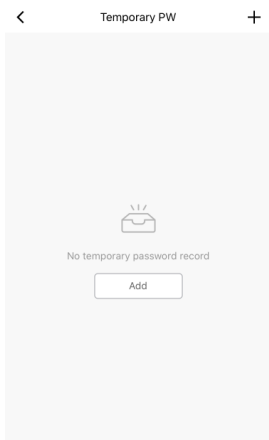

3. Input the password you want, or just click "Get Randomly" to generate the password;

4. Input the Name, Effect of time, Expire of time, and then click done to save the setting;

5. Activate the lock and synchronize the temporary the password to the lock

6. Use the password to unlock as daily.



After generate the password, make sure the password is synchronized to the lock

13 Remote Dynamic Password Unlock

1. Move to the interface of dynamic password;

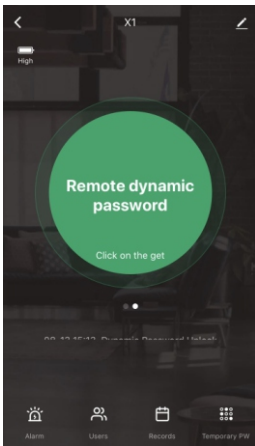

2. Click and icon and generate the password

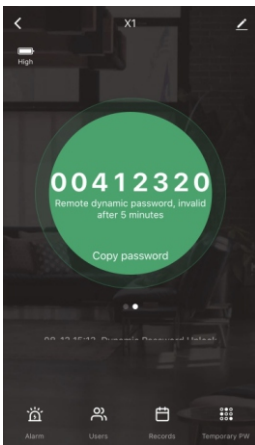

3. Use the password to unlock

 ***The password is only available in 5 minutes.***